

Removal, Cleaning and Installation of Fuel Pass Filter

Removal:

1. Unscrew the fuel line (55) from the fuel tank to the filter, at the filter (Fig. 47—6/1).

Note: If the fuel tank is full, fuel will flow out of the line.

“Highly inflammable!”

Plug the pipe immediately after it has been unscrewed!

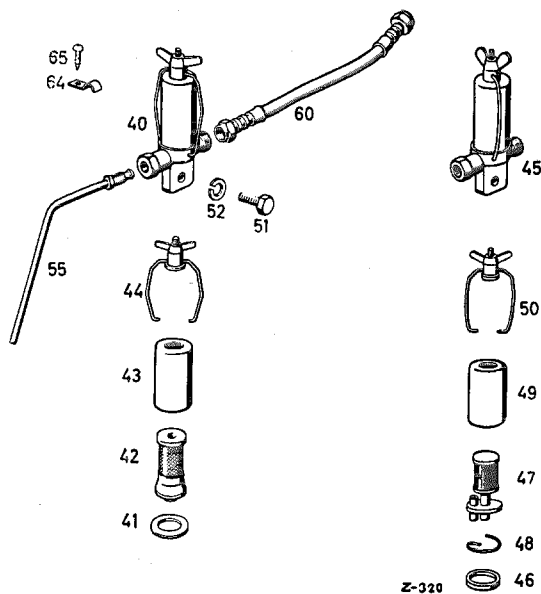

Fig. 47—6/1

- | | |
|---------------------|----------------------------|
| 40 Fuel pass filter | 49 Filter cup |
| 41 Seal | 50 Wire clamp |
| 42 Filter insert | 51 Hexagon screw |
| 43 Filter cup | 52 Lock washer |
| 44 Wire clamp | 55 Fuel line |
| 45 Fuel pass filter | 60 Flexible hose |
| 46 Seal | 64 Fixing clip |
| 47 Filter insert | 65 Oval-head tapping screw |
| 48 Circlip | |

2. Remove the fuel hose (60) from the filter to the fuel feed pump at the filter (Fig. 46—6/1).
3. Unscrew the hexagon screw (51) and take off the filter. Pay attention to the lock washer (52)!

Cleaning:

4. Slacken the wing nut, turn down the wire clamp at the side and take off the filter cup (Fig. 47—6/2).

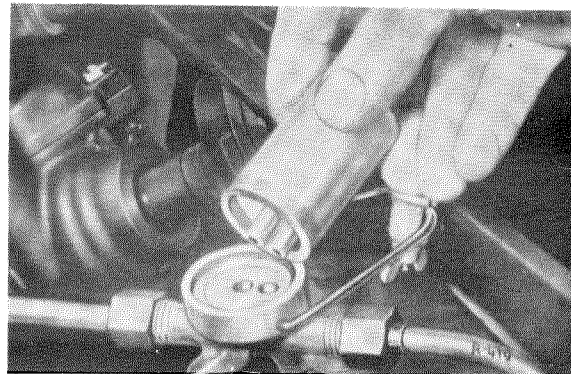

Fig. 47—6/2

5. Take out the filter insert (42) or (47). This procedure varies according to the version of the fuel pass filter (40) or (45). In the case of version (40), screw the filter insert (42) out of the lower part of the pass filter. In the case of version (45), the circlip (48) must first be removed and then the filter insert (47) taken out of the filter cup (49).
 6. Take out the seal (41) or (46) (see Fig. 46—6/1).
 7. Wash out the component parts of the filter in gasoline or trichloroethylene and blow out with compressed air.
 8. Put a new seal (41) or (46) in the filter housing (see Fig. 47—6/1).
 9. According to the version of the pass filter fitted, screw the filter insert (42) into the lower part of the filter (40) or alternatively, push the filter insert (47) into the filter cup (49) and insert the circlip (48).
 10. Put on the filter cup, turn up the wire clamp to the vertical position and tighten up the wing nut. Make sure that the filter cup is perfectly seated.
- ## Installation:
11. Install the filter, keeping to the logical order of procedure.
 12. Check the filter and the fuel lines for leakage.